

# ONE SHAPE

## Design by

Marie Christine Domer

## Description

The side table ONE SHAPE comes from the collection "Une forme, One shape" by Marie Christine Domer, exposed simultaneously in Paris and Tokyo in 2004. This collection is based on the idea of a single form that will be available in different sizes (from jewelry - ring, pendant - to a giant sculpture to the side table) and in all kinds of materials (metal, ceramic, glass, braided leather, rattan bark, solid wood...).

Ligne Roset decided to rerelease the side table.  
Side table made by assembly of 36 joined small squares of solid ash, sawn wood finish effect, flat black stained or side table in solid oak natural varnish, smooth finish.

## Technical Specifications

[www.ligne-roset.com](http://www.ligne-roset.com)

© Ligne Roset 2019



SOFA END TABLE NATURAL OAK

### DIMENSIONS

H 16 " - W 16 " - D 16 " -

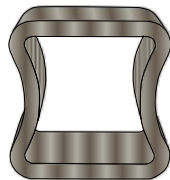

sofa end table natural oak

### DIMENSIONS

H 16 - "  
W 16 - "  
D 16 - "

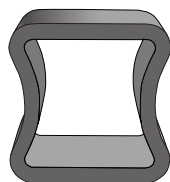

sofa end table american walnut

### DIMENSIONS

H 16 - "  
W 16 - "  
D 16 - "